

Zoom Camera

ATC-HZ5512W-U

- 1/1.8" SONY Progressive Scan Global Shutter CMOS
- 144x AF Zoom(12x optical zoom, 12x digital zoom)
- 1080p 60/50/30/25fps
- Mechanical Day&Night
- True WDR
- 3D DNR, Defog
- UART RS232-TTL(Pleco-D, Pelco C, VISCA, Hitachi)

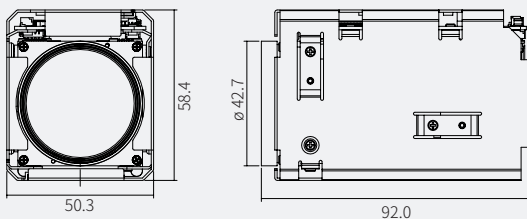

Zoom Camera

ATC-HZ5512W-U

Dimensions

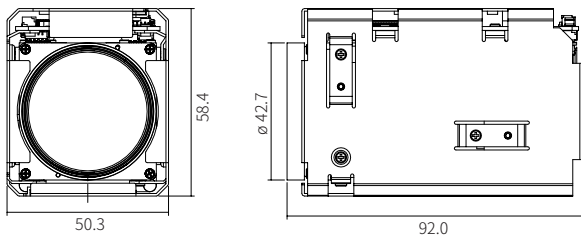

Specifications

Image Sensor	1/1.8" SONY Progressive Scan Global Shutter CMOS	D-WDR	Off/Low/Middle/High	
Effective Pixels	3.19MP 2064(H) x 1544(V)	WDR	Off/On, Adjustable(Level:0~29, Contrast:0~5, Bright:0~19)	
Video Output mode	USB / CVBS	BLC	Off/On, Area selectable	
Max. Video Resolution	USB :1080p@60(50fps)	HLC	Off/On, Area selectable	
Synchronization system	Internal / External Option	AGC	Max.48dB	
Min.Illumination	Day mode: 0.1(Lux(F1.5)) Night mode: 0.05Lux(F1.5/ IR-cut filter on) Sens-Up off, AGC45dB	Sharpness	Adjustable(0~15)	
S/N Rate	More than 55dB(AGC off, Sens-Up off)	3D-DNR	Off/Auto/Low/Middle/High	
Lens	Type	AF Optical zoom lens(DC Iris), IR Corrective	2D-DNR	Off/Auto/Low/Middle/High
	Focal Length	f=7.0mm~84mm	Defog	Off/On/Auto
	F-value	F1.5(W)~1.9(T)	Preset Position	256 position Presets(Zoom,Focus), 16Memory Presets, Custom Preset
	Angle of View	Horizontal 51.1°(W)~5.0°(T), Vertical 30.0°(W)~3.2°(T)	Language	English
Zoom ratio	Optical 12x / Digital 12x	UART	Remote	RS232 TTL +5.0V(+3.3V compatible)
Focus Min.Working Distance	0.1m(Wide)/0.5m(Tele)~∞		Protocol	VISCA/Pelco-D/Pelco-P/Hitachi: Automatic detection
Focus Control	Auto/Interval/One Push/Manual/Preset		Baud rate	2400/4800/9600/19200/38400/57600/115200bps
AE mode	Auto/Shutter Priority/Iris Priority/AGC Priority/Manual	UTC	-	
Brightness	0~14	Supply Voltage	12VDC(9V to 15VDC)	
Manual Shutter	1/1, 1/2, 1/4(3), 1/8(6), 1/15(12), 1/30(25), 1/60(50)~1/10000	Power Consumption	Max.6.0W / Non-working zoom&focus 4.5W	
Manual Iris	F1.6~F32, Close	Dimension(mm)	50.3X58.4X92.0mm	
Sense-up	Off~32fields	Weight	Approx.253g	
ETC	Spot AE, Slow AE	Operating Temperature	-10°C~+50°C, Humidity(20~80%)	
D&N Mode	Auto/Day(Color)/Night(BW)/External-H or L	Storage Temperature	-20°C~+60°C, Humidity(20~95%)	
White Balance	AUTO/One Push/Indoor/Outdoor/ATW/Manual			
Image Freeze	Off/On			
Image Flip	Off/Horizontal/Vertical/H+V(180° Flip)			
Privacy Mask Zone	8 Zones/14 mask color selectable			
Digital Image Stabilization	Yes			
Motion Detection	4 Zones			